



PH23



Cloud
Highly secure



ECOdesign 2018
compliant

SMART AND CONNECTED COLUMN CONTROLLER ECODESIGN COMPLIANT FOR ELECTRIC RADIATOR WITH FLUID INERTIA

Can be remotely-controlled thanks to a customizable mobile application, large full color touch screen, auto-programmable with self-learning process and dual optimization feature, occupancy detection, opened window detection, gauge and power consumption indication in kWh

Overview

Main features

- Ambient temperature control
- Temperature setting
- Power On / Standby
- Operating modes selection
- Quick heating of the room using the instant Boost
- Automatic and self-learning programming, customized integrated programming or can be programmed remotely using the 6-order pilot wire

Application

- Electric radiator

Benefits

- **Modern and innovative style** : polycarbonate column with exclusive style, extra-flat occupancy detector.
- **Directly connectable to the Internet through the Internet provider box without any other accessory**
- **Can be remotely-controlled by your smartphone, tablet or computer with a dedicated and customizable mobile application**
- **Excellent ergonomic settings: revolutionary full color touch screen interface easy to read**, intuitive navigation and easy to use, 2 independant buttons mode/back to the home screen
- **Adaptability: customizable display, interface adaptable to different user profiles** (housing, hotels, offices, public buildings) to adapt to each need
- **Latest generation advanced electronics with OTA microprocessor for software remote update**
- **"Smart" electronic control**: this means stable and accurate temperature in the room all year round
- **Energy Saving Pack, comfort, performance, energy savings**
- **Auto-programming** : automatic programming by self-learning of the lifestyle
- **Automatic changeover summer/winter time**
- **Active memory**: clock and settings are saved by EEPROM in case the mains power supply goes off

Functional specifications

Use



Comfort temperature setting	Preset to +19°C, adjustable from +7°C to +30°C
Eco temperature setting	Preset to +15,5°C, adjustable from +5°C to +19°C
Frost protection temperature setting	Preset to +7°C, adjustable from +5°C to +12°C
Operating modes	Auto (programming), Comfort, Eco, Boost, Frost protection, Holidays
Boost	Adjustable between 30 and 180 minutes in 10 minutes intervals: to rise quickly the temperature and turn on the heating for a time period requested
Programmable holidays mode	Frost protection for a long scheduled absence
Energy consumption gauge	Automatic indication of the level of energy consumption according to the setting temperature
Power consumption indication in kWh	Posting of the estimated amount of energy consumed in kWh since the last 24 hours or since the last reset to 0 of the energy meter
Opened window detection	Automatic switching to Frost protection mode when a significant drop in temperature is detected
Window airing feature	Manual window airing can be enables at any time
Occupancy detection	During an unoccupied period, the setting temperature is automatically and progressively decreased
Auto-programming	As soon as the device is switched on and without any initial adjustment, the device is in learning mode to understand and memorize the user's lifestyle. The integrated smart algorithm is going to analyze this information in real time in order to optimize and adapt the programme for the coming weeks



Digital control with full color touch screen

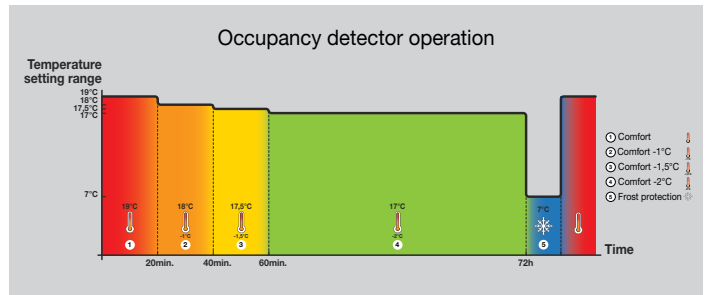

Programming	<ul style="list-style-type: none"> - 7 different preset program profiles for each day of the week: Auto-programming, P1, P2, P3, P4, P5, non-stop Comfort mode, non-stop Eco (economy) mode - Programming assistant to help the user step by step - P1, P2, P3, P4, P5, non-stop Comfort mode and non-stop Eco mode programmes can be customised - Manual and temporary overriding of a programme
Dual optimization feature	Depending on different parameters of the room, the controller calculates and optimizes the programming of Comfort and economy periods (Eco) according to the choice of the user; Eco oriented , priority to savings or Comfort oriented , priority to comfort (by default)
Help for the visually impaired	<ul style="list-style-type: none"> - The button power on/standby mode is in relief to be easily identifiable to the touch - Audible beeps indicating the change from the standby mode to active mode
Safety	<ul style="list-style-type: none"> - Child anti-tamper: touch screen locking - Settings safety : <ul style="list-style-type: none"> - Min. and Max limits of the adjustment range of the Comfort setting temperature - Customizable PIN code locking (prevents access to the Comfort mode, advanced and expert settings) - Time, date and setting backup in case the mains power supply goes off - Internal protection against any overheating
3 levels of settings	User, Advanced, Expert

Installation

Column holder supplied, to be mounted directly on the radiator

Easy to install: Waiting position when mounting column to facilitate the connexion to the electric cartridge

Connexion to the heating cartridge by faston

Setup assistant	On first power-up : simple and fast procedure to setup the main settings Setup assistant can be accessed later to view and modify registered settings
------------------------	--

User settings

Language use	Preset to French , English available
Wifi connexion	Direct internet connexion through the Internet provider box thanks to a dedicated mobile app
Display	Backlight duration and brightness, choice of a screen color theme possible
Regional units	Temperature unit, date and time format, automatic changeover summer/winter time can be disabled
Return to the user factory settings	

Advanced settings

Occupancy detection	Enabled by default , can be disabled
Automatic window-opening detection	Enabled by default , can be disabled
User profile	4 profiles available to meet each need: Individual housing, buildings receiving public, hotels or offices
Min. setpoint temperature	Preset at +7°C , adjustable from +7°C to +18°C
Max. setpoint temperature	Preset at +30°C , adjustable from +19°C to +30°C
Boost duration	60 minutes by default , adjustable from 30 to 180 minutes by 10 minutes steps
Window airing cycle duration	30 minutes by default , adjustable from 5 to 90 minutes by 5 minutes steps

Expert settings

Temperature adjustment	Ambient temperature sensor adjustment with automatic adjustment
PIN code locking	Initialization - Customization - Activation and deactivation
Reset: return to the advanced and expert factory settings	

Technical specifications

Dimensional and finish specifications

Height	580 mm
Width	76 mm
Depth	80 mm
Color	White
Net weight	1,4 Kg

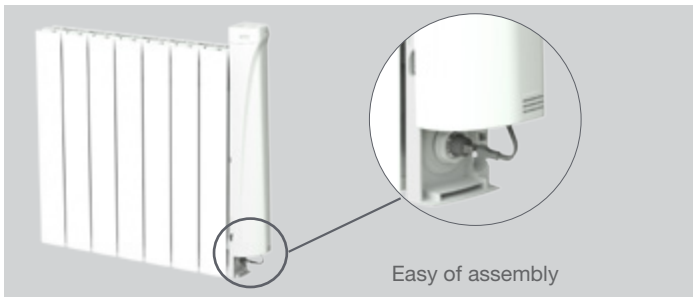

Power supply

Operating voltage	230V AC+/-10% 50Hz
Maximum power	2000W resistive load
Power cord	900 mm, 3 conductors

Control

Control type	Electronic PID (Proportional Integral Derivative) control, triggered by a triac
--------------	---

Environment

Protection rating	IP24 after installation under the responsibility of the integrator
Class	Class II, after installation under the responsibility of the integrator
Operating temperature	0°C to +60°C
Temperature setting range	+7°C to +30°C
Storage temperature	-20°C to +70°C
NTC electronic temperature sensor	

Applicable directives

RED	2014/35/EU
RoHS	2011/65/EU

Applicable standards

RED - Safety	EN60335-1; EN60335-2-30; EN62233
RED - EMC	ETSI EN301489-17; ETSI EN301489-17
RED - Radio	EN300328-1
RoHS	EN50581
Manufacturing	On certified site ISO 9001 V2015

Product code

Code	Description
COCPH23I30A	Connected right-hand column with occupancy detection, white for radiator with fluid inertia, Class II, 80mm, 6 order-pilot wire

Product customization (style, features) possible on request. Please contact us.